

TOP VIEW
SCALE 1:30

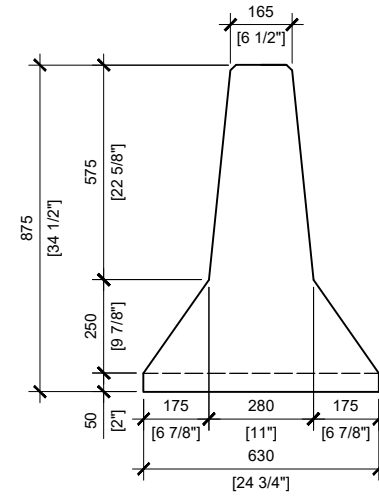

SECTION A
SCALE 1:20

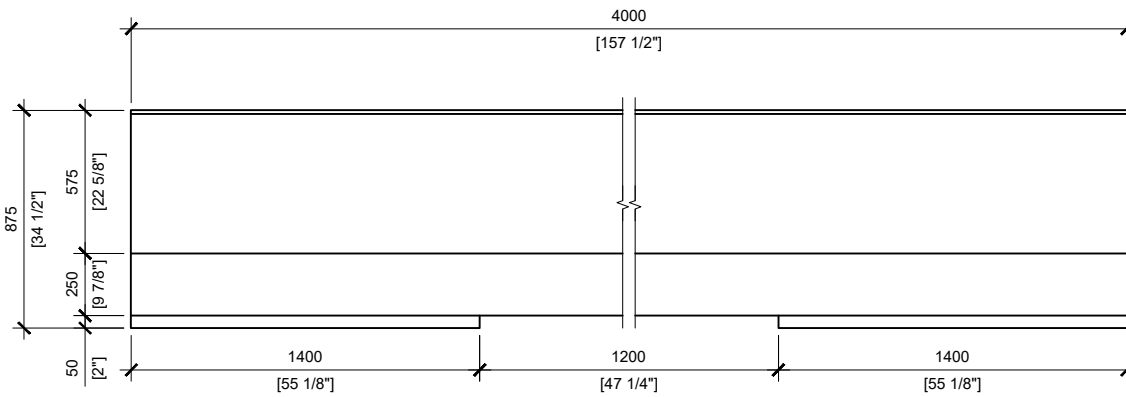

FRONT VIEW
SCALE 1:30

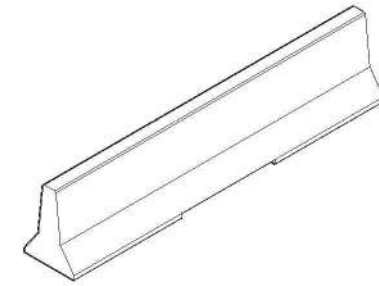

GENERAL NOTES:

1. ALL UNITS MUST BE HANDLED WITH PROPER LIFTING EQUIPMENT (I.E. SPREADER BAR)
2. REINFORCING SHALL BE SIZE SPECIFIED AND GRADE 400W DEFORMED STEEL BARS. CONCRETE COVER SHALL BE 50MM MINIMUM
3. ALL CONCRETE EDGES SHALL HAVE 15X45° CHAMFER
4. WELDS SHALL BE ACCORDING TO CSA W59 AND CSA W186
5. ALL DIMENSIONS ARE IN MILLIMETERS UNLESS OTHERWISE SHOWN.



MANUFACTURED:
OTTAWA, ON
613-822-1488

www.powerprecast.com

CONCRETE TYPE: SCC
 CONCRETE: 45MPa / 6,526PSI
 AIR CONTENT: 6.5% ± 1.5%
 REINFORCEMENT : STEEL TO CSA CAN
 A23.4-05 / A23.3. G30.18 Fy=400MPa

WEIGHT: 5,676lbs / 2,580kg

SHEET:
1/1

DWG NO.
B - 1.12

DRAWN BY:
E.ZHOU

DATE:
DEC/2019

4M MEDIAN BARRIER - NO END CONNECTIONS

PPS REFERENCE: 409922